

ALL DIMENSIONS AND LOCATIONS SHOWN ARE BASED ON THE RECORD PLANS AND SURVEY DATA PROVIDED BY THE CLIENT. THE CLIENT IS RESPONSIBLE FOR THE ACCURACY OF THE DATA PROVIDED. THE ENGINEER HAS CONDUCTED A VISUAL GENERAL VERIFICATION OF THE DATA AND HAS FOUND NO APPARENT ERRORS. THE ENGINEER DOES NOT WARRANT THE ACCURACY OF THE DATA OR THE RESULTS OF THE SURVEY. THE ENGINEER'S RESPONSIBILITY IS LIMITED TO THE DESIGN AND CONSTRUCTION OF THE PROJECT AS SHOWN ON THESE PLANS. THE ENGINEER IS NOT RESPONSIBLE FOR ANY ERRORS OR OMISSIONS IN THESE PLANS OR FOR ANY CONSEQUENCES ARISING FROM THE USE OF THESE PLANS. THE ENGINEER'S LIABILITY IS LIMITED TO THE AMOUNT OF THE FEE PAID FOR THE SERVICES PROVIDED. THE ENGINEER'S LIABILITY DOES NOT EXTEND TO ANY OTHER PROJECTS OR TO ANY OTHER PARTIES. THE ENGINEER'S LIABILITY IS LIMITED TO THE AMOUNT OF THE FEE PAID FOR THE SERVICES PROVIDED. THE ENGINEER'S LIABILITY DOES NOT EXTEND TO ANY OTHER PROJECTS OR TO ANY OTHER PARTIES.

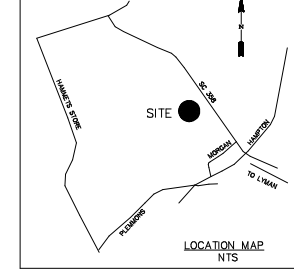
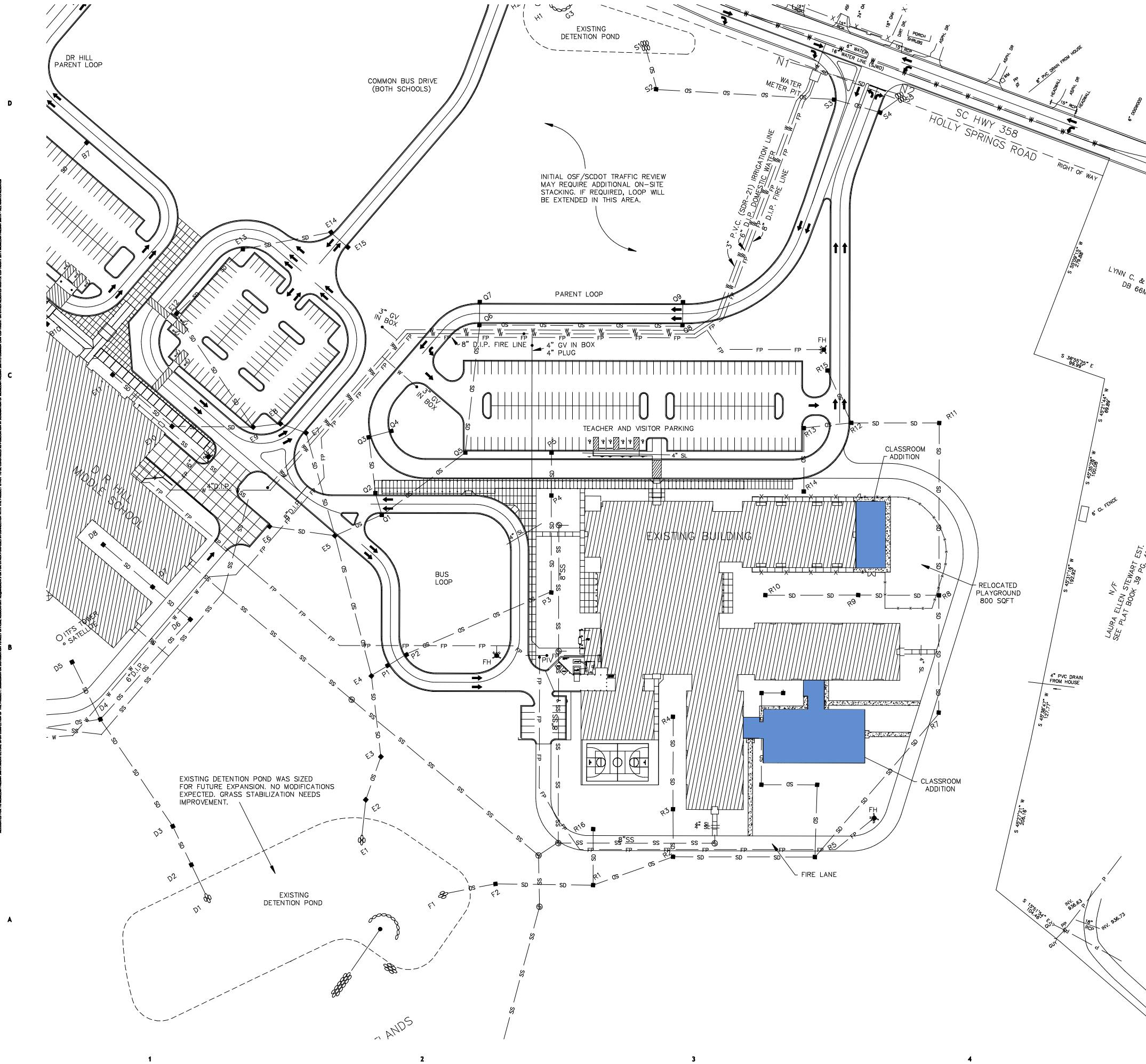

mcmillan | pazan | smith
 architecture
 asheville charleston greenville spartanburg
 po box 8522 greenville, sc 29604-0522
 www.mcmillanpazansmith.com

BLACKWOOD ASSOCIATES INC.
 CONSULTING ENGINEERS
 PO BOX 366
 SPARTANBURG, SC 29304
 864-583-5432 FAX-583-5434

DISTRICT FIVE SCHOOLS OF SPARTANBURG COUNTY
**NEW CLASSROOM BUILDING
 LYMAN ELEMENTARY SCHOOL**
 1227 HOLLY SPRINGS ROAD
 LYMAN, SOUTH CAROLINA 29365

SHEET ISSUE NO.	DATE	DESCRIPTION	BY

PRINCIPAL IN CHARGE: **WAB**
 PROJECT ARCHITECT: **WAB**
 DESIGNER: **WAB**
 SHEET TITLE:

SITE PLAN

SHEET NO. **CV-1** PROJECT NO. **13400.01**

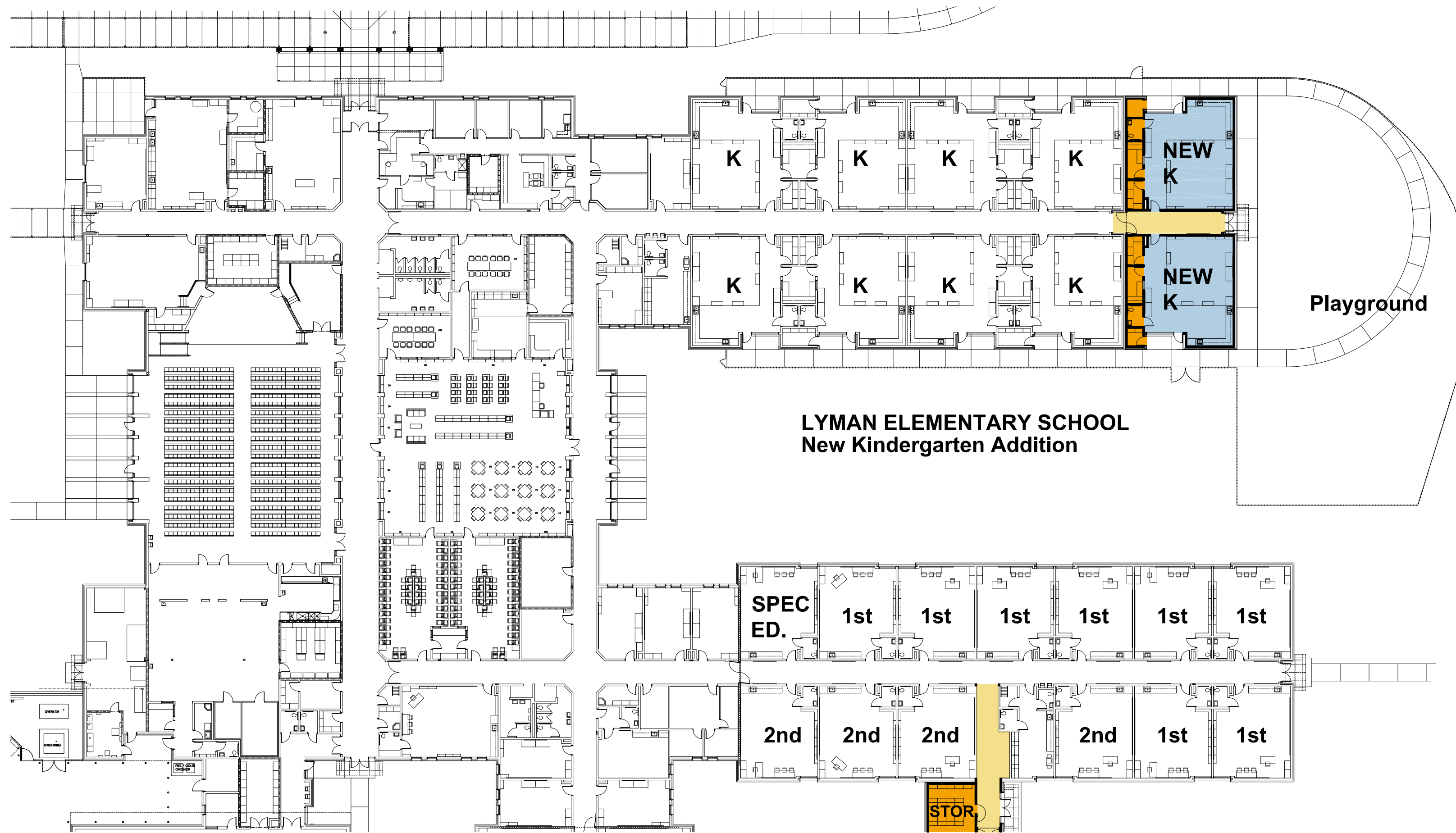

**LYMAN ELEMENTARY SCHOOL
New Kindergarten Addition**

Playground

K

K

K

K

NEW
K

K

K

K

K

NEW
K

SPEC
ED.

1st

1st

1st

1st

1st

1st

2nd

2nd

2nd

2nd

1st

1st

STOR.

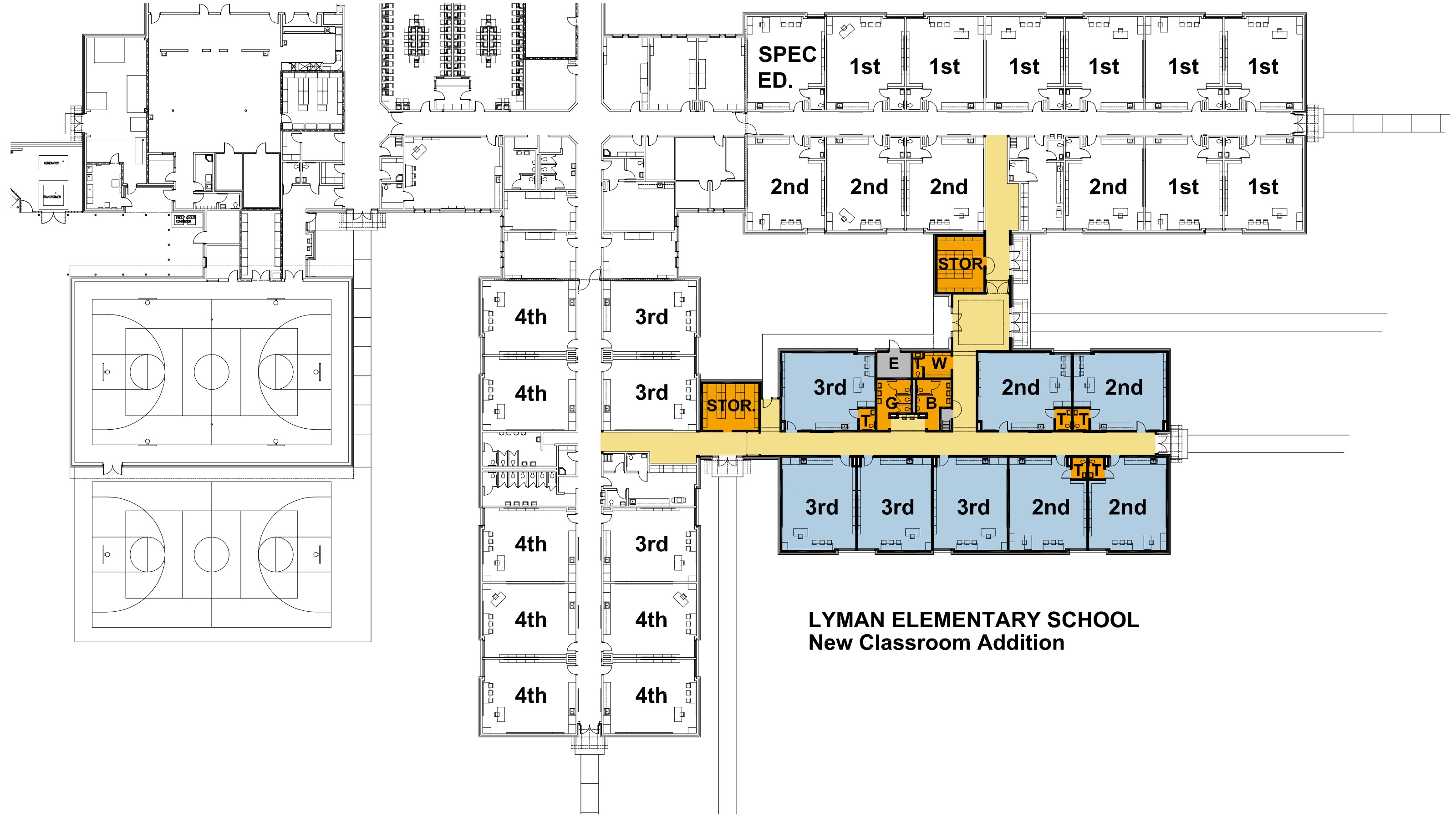

SPEC ED.

1st

1st

1st

1st

1st

1st

2nd

2nd

2nd

2nd

1st

1st

STOR.

4th

3rd

3rd

E

W

2nd

2nd

STOR.

G

B

3rd

3rd

3rd

2nd

2nd

4th

3rd

4th

3rd

4th

4th

4th

4th

**LYMAN ELEMENTARY SCHOOL
New Classroom Addition**