

HWY 29 ELEMENTARY SCHOOL

LS3P



Thompson Turner
Construction





HWY 29 ELEMENTARY SCHOOL - SITE PLAN

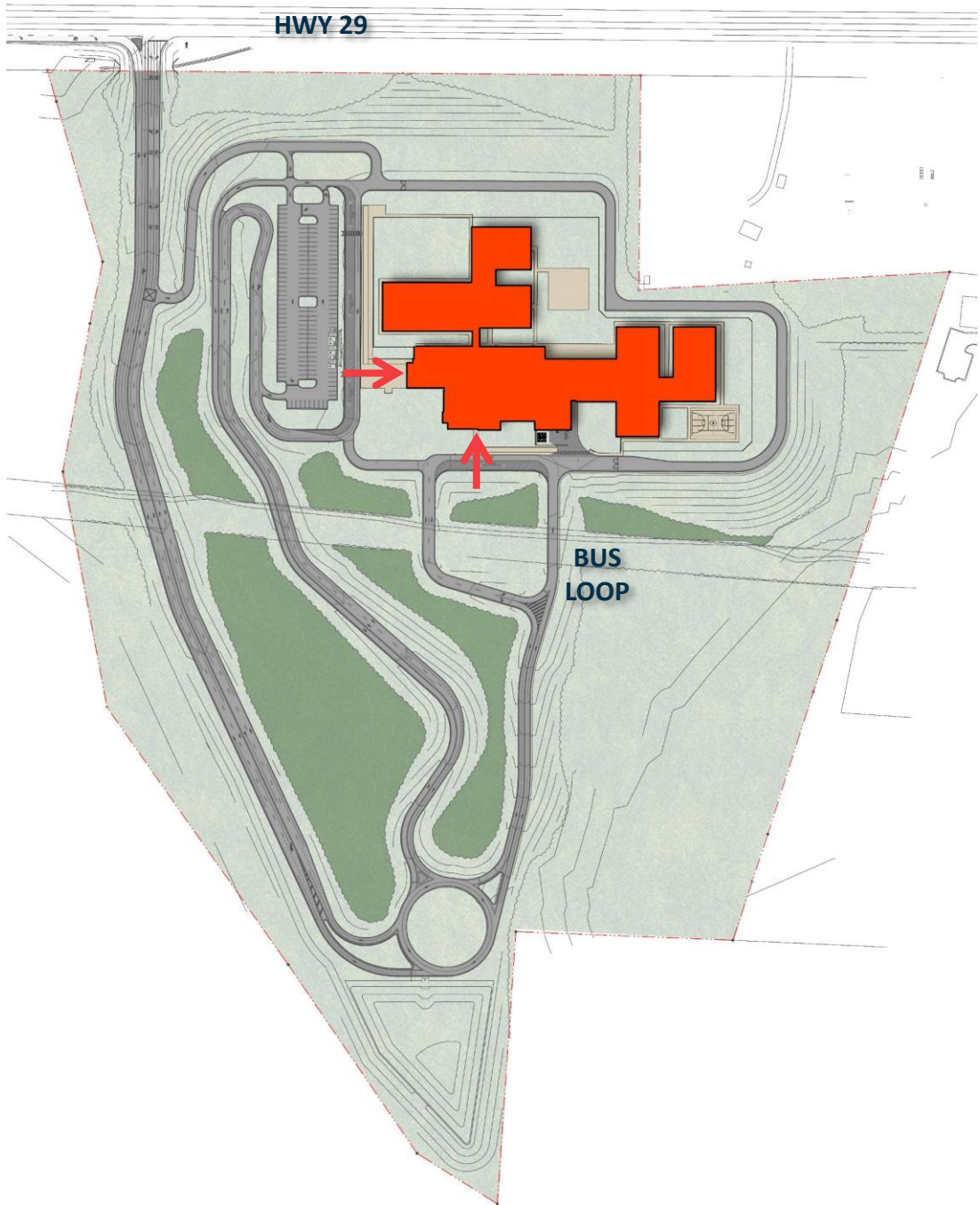

**56 Acres Total
45 Acres Disturbed**

**Separated Parent Drop-Off
And Bus Loop**

One Entry from HWY 29

SCDOT Approved Boulevard Access

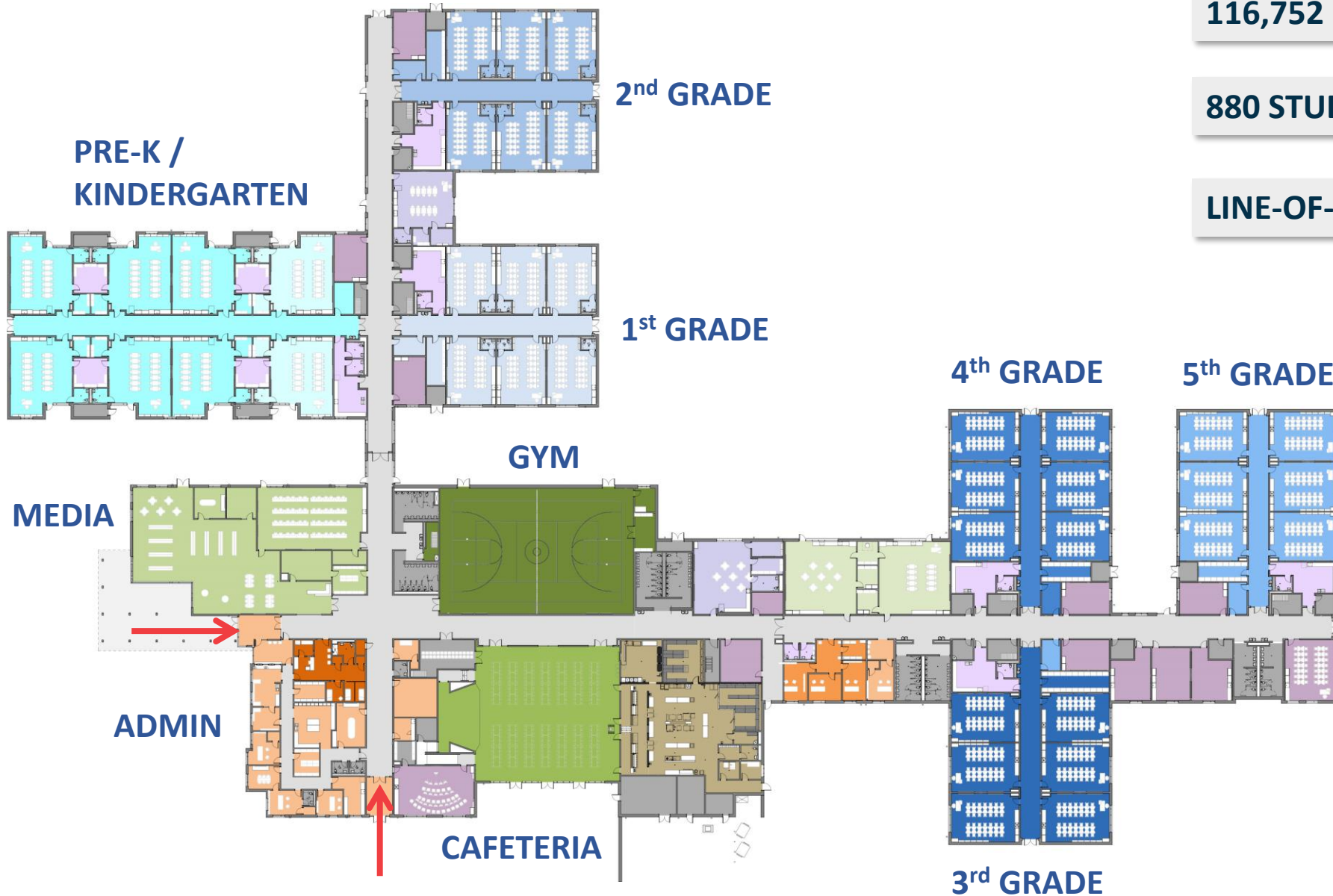

116,752 GROSS SF

880 STUDENTS / 900 CORE

LINE-OF-SIGHT CORRIDORS

**GUARANTEED MAXIMUM PRICE
PRESENTATION TO THE BOARD OF TRUSTEES**

| | |
|---------------------------------------|---------------------|
| Early Site (previously approved) | \$10,142,004 |
| Building (request for approval) | \$37,617,662 |
| 4% Contingency included = \$1,730,315 | |
| TOTAL | \$47,759,666 |

HWY 29 ELEMENTARY SCHOOL

LS3P



Thompson Turner
Construction

