



Facilities Update 5/23/22



Portable Mobilization



EVERY CHILD, EVERY DAY.

Reidville Elementary



- June 1-June 8: Units arrive
- June 6-13: Set-up and skirting
- June 20-24: Install canopies and ramps
- June 27: Begin electricity & sewer



Byrnes High School



- June 6-June 13: Units arrive
- June 13-20: Set-up and skirting
- June 20-24: Install canopies and ramps
- June 27: Begin electricity and sewer



Construction Projects



EVERY CHILD, EVERY DAY.

Byrnes High School Phase 2



EVERY CHILD, EVERY DAY.



EVERY CHILD, EVERY DAY.



Completed:

- Under ground electrical, mechanical and plumbing at front entrance

Upcoming:

- Storm drain installation in front of building
- Final mechanical and plumbing connections
- Demolition Phases 1-6 (May 31-August 1)



Demolition June 1-August 1

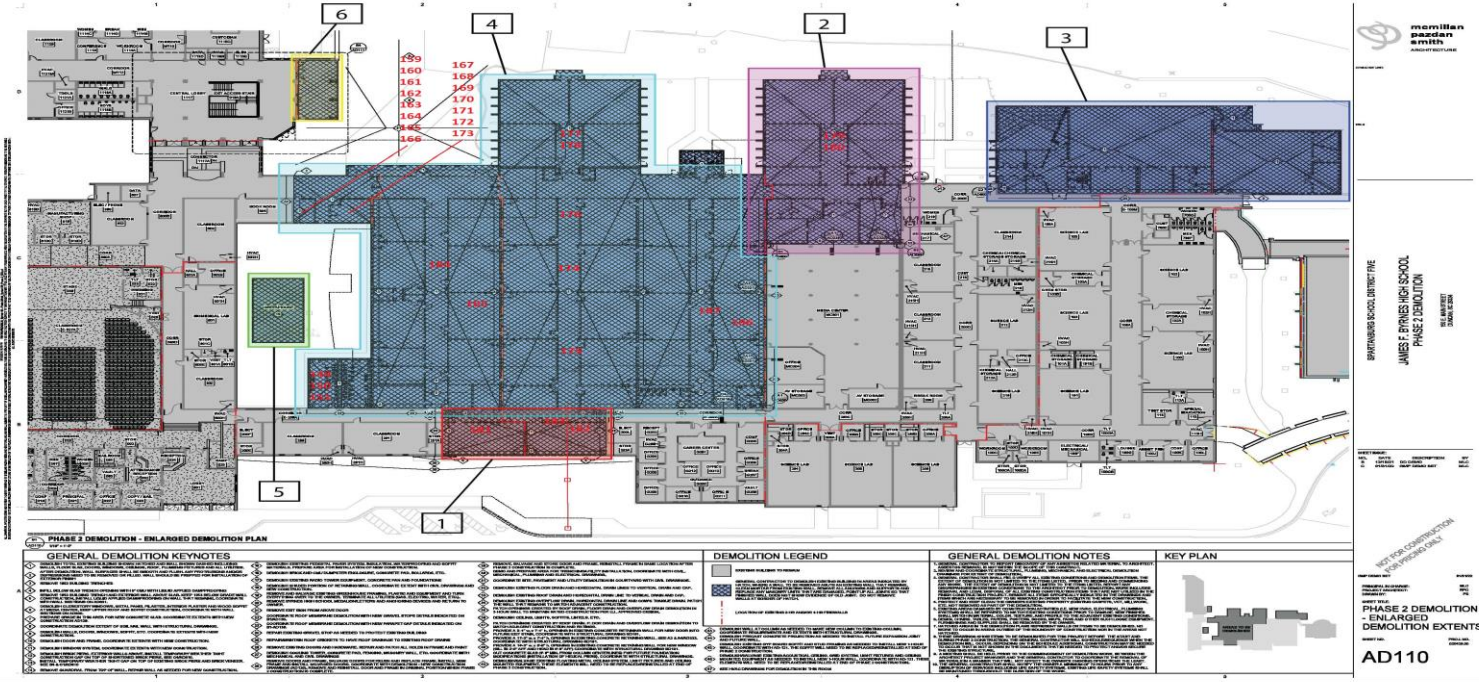

EVERY CHILD, EVERY DAY.

Byrnes Phase 2



Developmental Design and Pricing phase

June 27, 2022: Site GMP

July 2022: Building GMP



Beech Springs



Developmental Design and Pricing

Next Step

- Final Site approval from SCDOT

June 27, 2022: Project GMP

June 15, 2024: Target move-in date





mcmillan | pazdan | smith
ARCHITECTURE

BEECH SPRINGS MIDDLE SCHOOL
SPARTANBURG COUNTY SCHOOL DISTRICT FIVE

200 DANZLER RD,
DUNCAN, SC 29334

FRONT ENTRY PERSPECTIVE

05/17/22

EVERY CHILD, EVERY DAY.

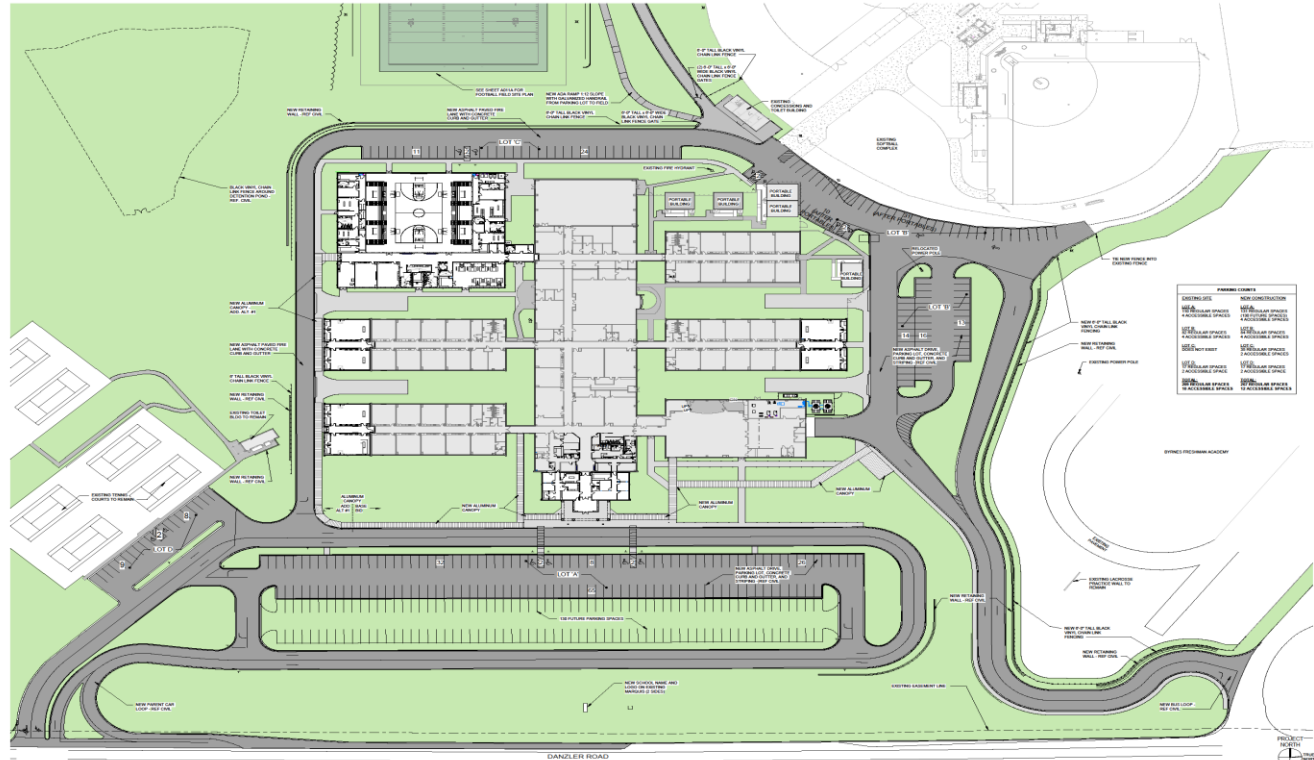

 **mcmillan | pazdan | smith**
ARCHITECTURE

BEECH SPRINGS MIDDLE SCHOOL
200 DANZLER RD.
DUNCAN, SC 29334
08/17/22

ARCHITECTURAL SITE PLAN

EVERY CHILD, EVERY DAY.

Berry Shoals



Work In progress:

- Portable electrical preparation
- Soil Delivery
- Construction begins June 6, 2022

August 2023: Target move-in date





EVERY CHILD, EVERY DAY.



New Elementary (Hwy 29)



- Design Development Phase
- May 17, 2022: Duke Energy preliminary site design approval
- May 23: Early site GMP
- August 29: Building GMP
- Sewer easement ongoing



Reidville Elementary Addition



July 2022: Early site GMP

Sept. 26, 2022: Building GMP

August 2023: Target move-in date



New Wellford Academy



Schematic Design Phase

Oct. 24, 2022: Early Site GMP

Nov. 21,: Building GMP

August 2024: Target move-in date



Hwy. 296 and Pine St. Signal



- Signal plan in design phase
- May 18: SCDOT preliminary meeting
- May 27: Preliminary plan to SCDOT
- July 1: Project bid by SCDOT approved contractor



New Abner Creek Middle School



Work Completed:

- Mass Grading

Work in Progress:

- Foundation pours
- Storm Drain and water line installation
- Gym wall construction

Work to Begin:

- Cafeteria Foundations
- Curb and gutter preparation





EVERY CHILD, EVERY DAY.



EVERY CHILD, EVERY DAY.





EVERY CHILD, EVERY DAY.





EVERY CHILD, EVERY DAY.



EVERY CHILD, EVERY DAY.