



**mcmillan
pazdan
smith**
ARCHITECTURE

HARPER

GENERAL CONTRACTORS

Reidville Elementary School Additions



Reidville Elementary - Site Plan

Approximately 23,890sf of
New Construction area

New Kindergarten
Courtyard Playground

Modified Fire Truck
Access Lane

DOT Required Car Loop
Extension – Not included
in GMP

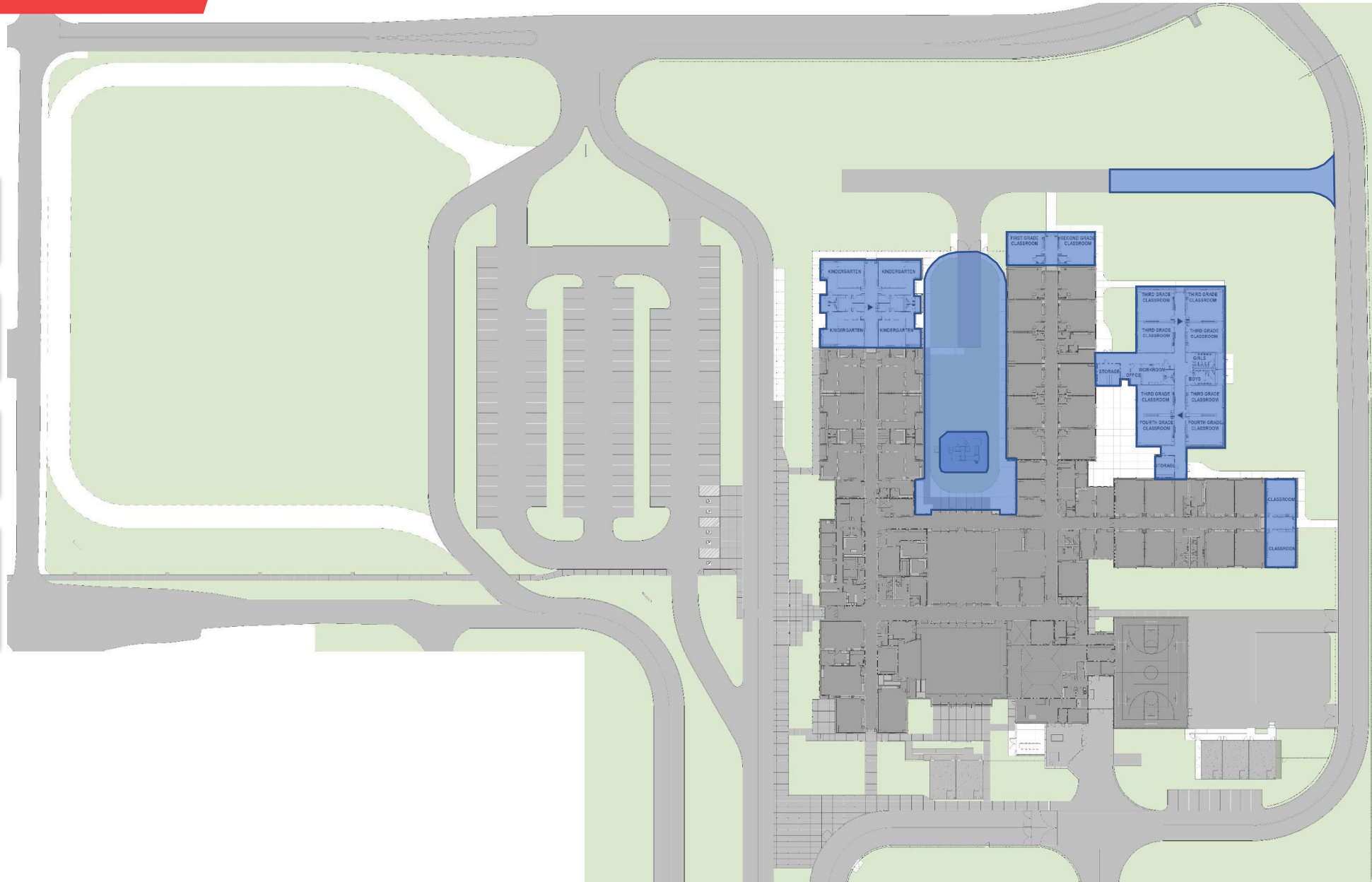

Reidville Elementary - Floor Plan

(4) New Kindergarten Classrooms

(6) New 1st & 2nd Grade Classrooms

(6) New 3rd – 5th Grade Classrooms and Group Toilets

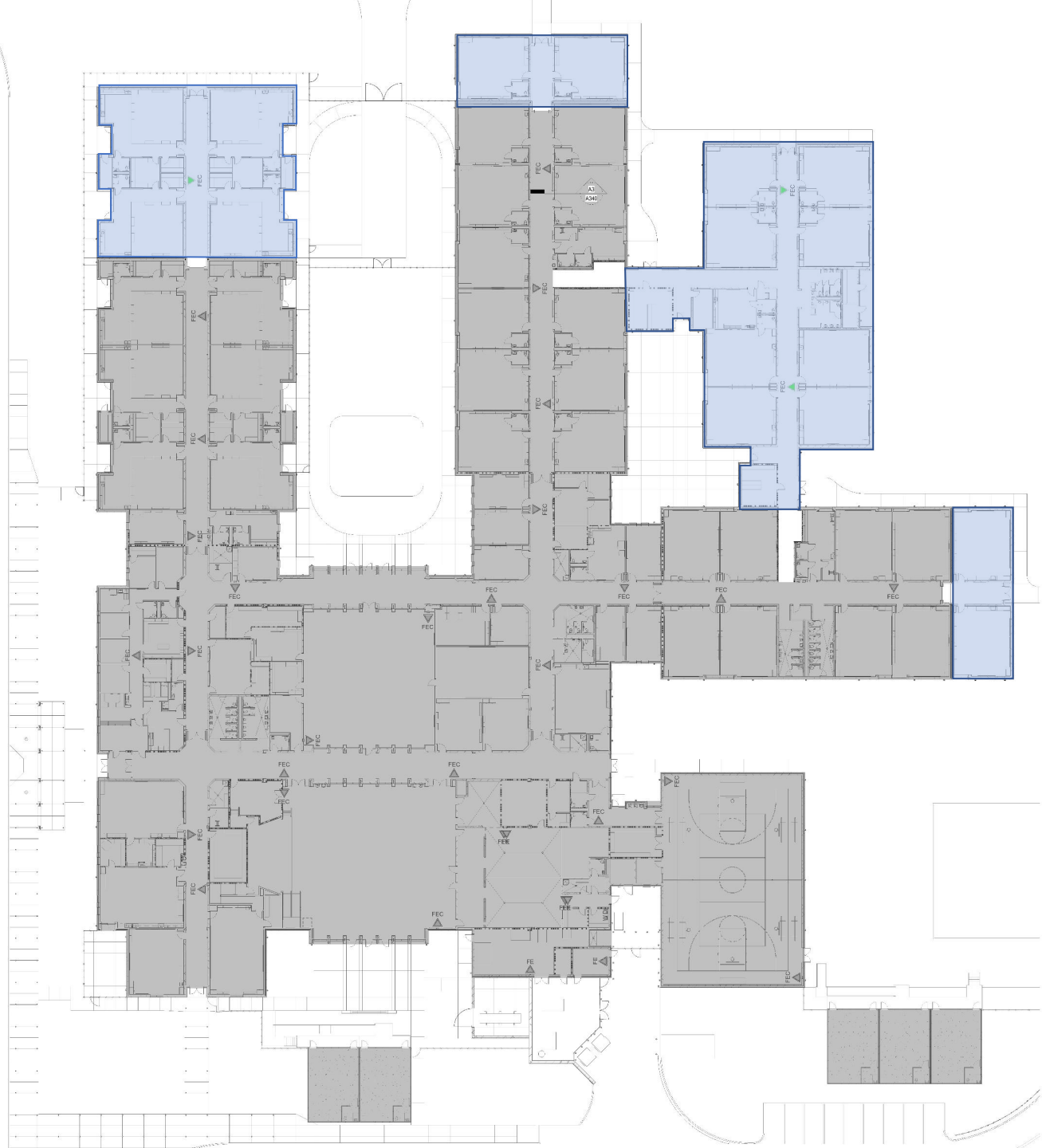

Reidville Additions – Final GMP

Reidville Elementary School Addition

Construct sixteen classrooms, modifications to the existing fire lane, Reidville Road traffic signalization, modular set-up and demobilization

GUARANTEED MAXIMUM PRICE PRESENTATION TO THE BOARD OF TRUSTEES	
Early Release GMP – Approved 7/18/22	\$6,339,591
Building GMP	\$3,768,912
Total to Date GMP	\$10,108,503

Total GMP includes a 5%Contingency
Total GMP does not include costs for new DOT required
Car Loop extension

