

SPARTANBURG COUNTY SCHOOL DISTRICT FIVE
SOFTBALL STADIUM AT BEECH SPRINGS

200 DANZLER RD.
DUNCAN, SC 29534

SHEET ISSUE:				
NO.	DATE	DESCRIPTION	BY	MLC
A	02/19/21	OSF DD REVIEW		MLC

NOT FOR CONSTRUCTION

PRINCIPAL IN CHARGE: MLC
PROJECT ARCHITECT: RPC
DRAWN BY: RPC

SHEET TITLE:
ARCHITECTURAL SITE PLAN

SHEET NO. PROJ. NO.
A010 020430.00

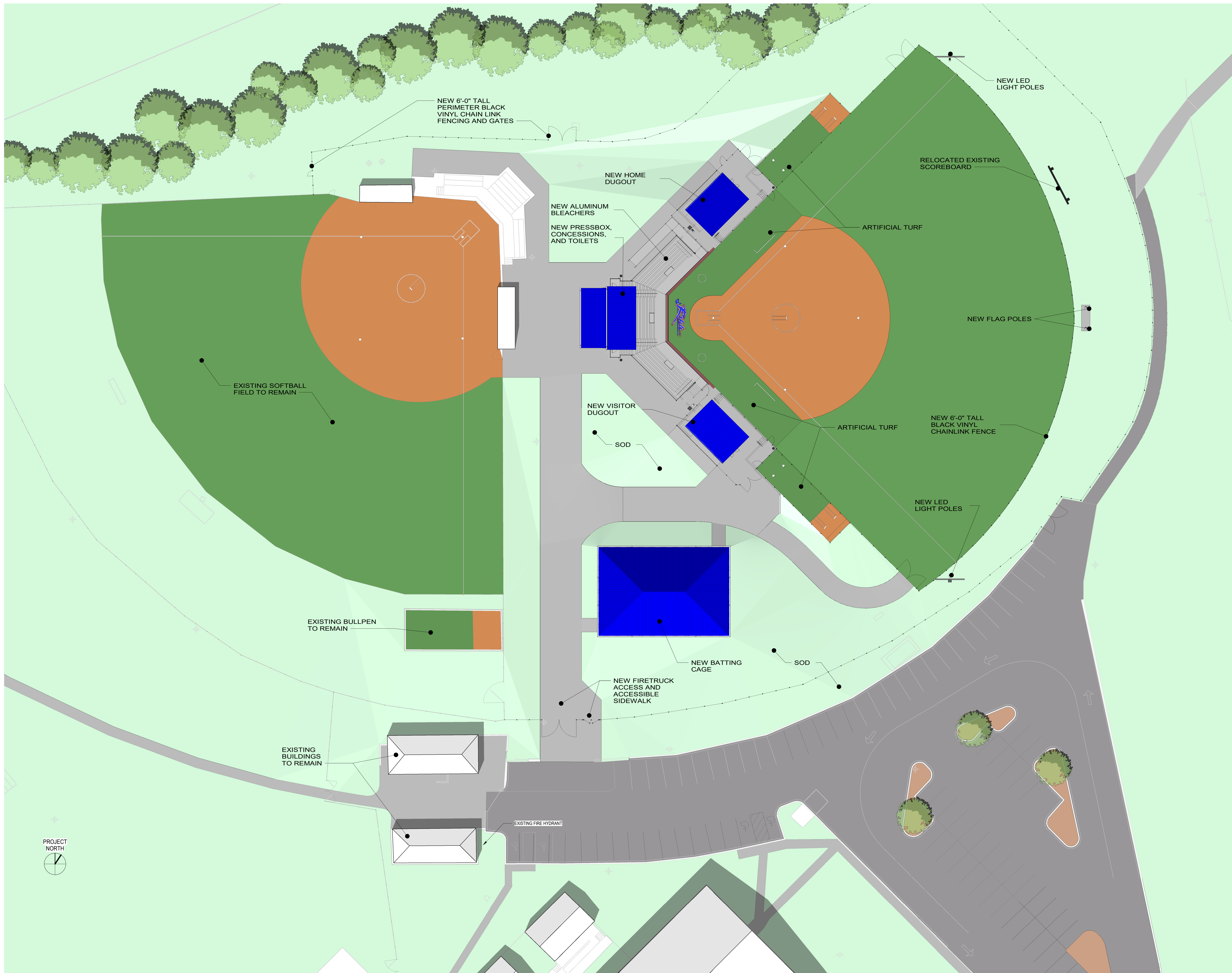

ALL DRAWINGS, SPECIFICATIONS AND COPIES THEREOF FURNISHED BY MCMILLAN PAZDAN SMITH ARCHITECTURE ARE AND SHALL REMAIN THE PROPERTY OF MCMILLAN PAZDAN SMITH ARCHITECTURE. THESE DRAWINGS ARE TO BE USED ONLY WITH RESPECT TO THE PROJECT AND NO PART OF THESE DRAWINGS IS TO BE REPRODUCED OR TRANSMITTED IN ANY FORM OR BY ANY MEANS, ELECTRONIC OR MECHANICAL, INCLUDING PHOTOCOPYING, RECORDING, OR BY ANY INFORMATION STORAGE AND RETRIEVAL SYSTEM, WITHOUT THE WRITTEN PERMISSION OF MCMILLAN PAZDAN SMITH ARCHITECTURE. MCMILLAN PAZDAN SMITH ARCHITECTURE ASSUMES NO LIABILITY FOR ANY ERRORS OR OMISSIONS IN THESE DRAWINGS. ALL RIGHTS RESERVED.